

Melvin Burgess
Assessor Of Property
Shelby County Government

Property Location and Owner Information

Parcel ID	093500 00566
Property Address	7114 WINCHESTER RD
Municipal Jurisdiction	MEMPHIS
Neighborhood Number	00910C51
Tax Map Page	199A
Land Square Footage	667600
Acres	15.326
Lot Dimensions	
Subdivision Name	MARKET OF RIVERDALE BEND PD PHASE 1
Subdivision Lot Number	
Plat Book and Page	291-016
Number of Improvements	3
Owner Name	RIVERDALE CENTER INVESTORS LLC
Owner Mailing Address	1825 MAIN
Owner City/State/Zip	WESTON FL 33326

Appraisal and Assessment Information

Class	COMMERCIAL
Land Appraisal	\$2,852,600
Building Appraisal	\$2,861,800
Total Appraisal	\$5,714,400
Total Assessment	\$2,285,760
Greenbelt Land Appraisal	\$0
Homesite Land Appraisal	\$0
Homesite Building Appraisal	\$0
Greenbelt Appraisal	\$0
Greenbelt Assessment	\$0

Improvement/Commercial Details

Land Use	- STORE DISCOUNT
Total Living Units	
Structure Type	DISCOUNT DEPT STORE
Year Built	1998
Investment Grade	C

Other Buildings

Card	Year Built	Length	Width	Area	Type
1	1998			210,000	PAVING ASPHALT 200,001-500,000
2	1998			2,904	TRUCK/TRAIN WELLS

Permits

Date of Permit	Amount of Permit	Permit Number	Reason
03/27/2023	\$677,345	COM-ALT-22-000965	ALT
09/01/2020	\$1,170,351	B1116222	ALT
06/12/2013	\$16,500	B1053316	ALT
10/19/2011	\$190,285	B1036415	TFN
12/01/2010	\$0	BC0000823	UO
11/06/2008		B1010888	UO
07/21/2008		B1006191	UO
02/17/2004	\$525,000	B0912037	ADD
09/30/2003		B0915155	REP
11/06/2001	\$83,000	B0875920	
07/24/2001	\$108,000	B0864849	

Sales

Date of Sale	Sales Price	Deed Number	Instrument Type
05/20/2015	\$0	20018771	QC
05/20/2015	\$0	20018774	QC
05/20/2015	\$0	20018779	QC
07/02/2013	\$6,150,000	13083873	SW
09/10/2010	\$1,750,000	10094875	SW
10/28/2009	\$4,753,000	09126070	TD
12/15/2006	\$14,500,000	06208923	WD
12/15/2006	\$0	07148231	CD

Sketch

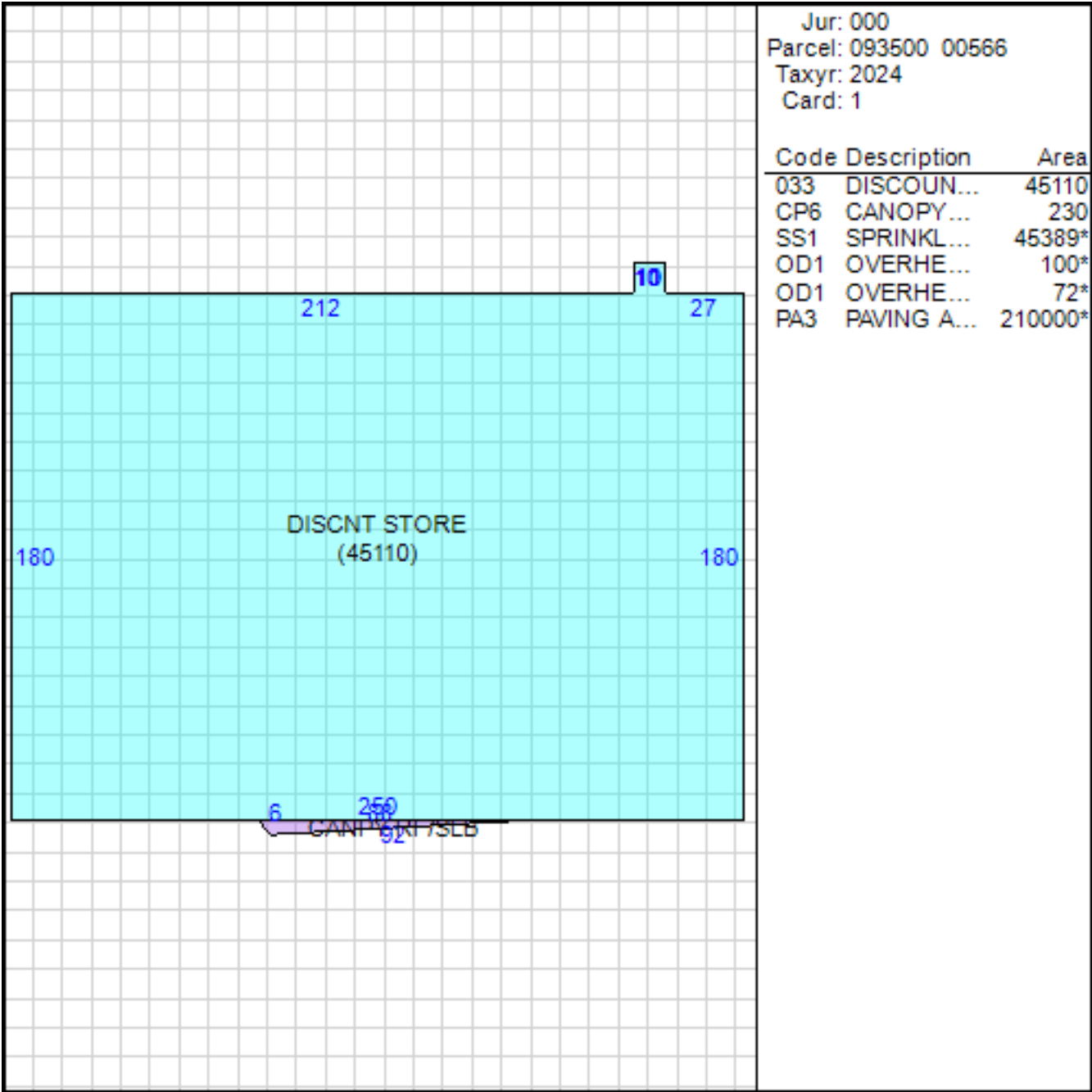

Sketch

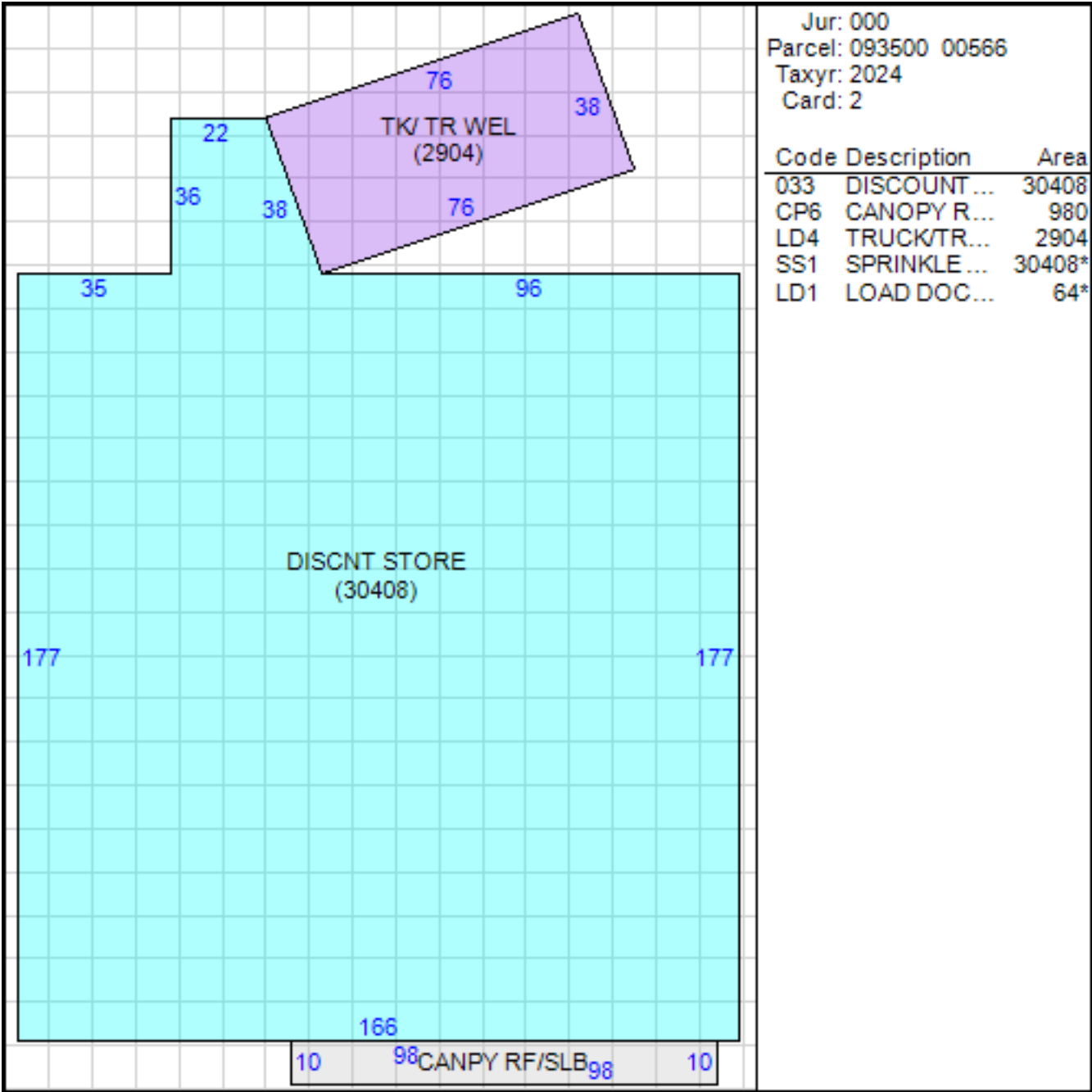

Sketch

