

Melvin Burgess  
Assessor Of Property  
Shelby County Government

Property Location and Owner Information

Parcel ID	076103 00022
Property Address	4738 STACEY RD
Municipal Jurisdiction	MEMPHIS
Neighborhood Number	00806D01
Tax Map Page	213G
Land Square Footage	8364
Acres	0.192
Lot Dimensions	
Subdivision Name	SMITH TURLEY
Subdivision Lot Number	0215
Plat Book and Page	
Number of Improvements	1
Owner Name	SMITH ROSIE L AND MAURICE C BENTON AND MAUTRICE L MEADE
Owner Mailing Address	4783 STACEY
Owner City/State/Zip	MEMPHIS TN 38109

## Appraisal and Assessment Information

Class	RESIDENTIAL
Land Appraisal	\$15,500
Building Appraisal	\$106,800
Total Appraisal	\$122,300
Total Assessment	\$30,575
Greenbelt Land Appraisal	\$0
Homesite Land Appraisal	\$0
Homesite Building Appraisal	\$0
Greenbelt Appraisal	\$0
Greenbelt Assessment	\$0

## Improvement/Commercial Details

Stories	1
Exterior Walls	BRICK VENEER
Land Use	- SINGLE FAMILY
Year Built	1964
Total Rooms	5
Bedrooms	3
Bathrooms	1
Half Baths	1
Heat	CENTRAL A/C AND HEAT
Fuel	NOT APPLICABLE
Heating System	NOT APPLICABLE
Fireplace Masonry	0
Fireplace Pre-Fab	0
Ground Floor Area	1287
Total Living Area	1287
Car Parking	CARPORT

Other Buildings

Card	Year Built	Length	Width	Area	Type
------	---------------	--------	-------	------	------

---

## Permits

Date of Permit	Amount of Permit	Permit Number	Reason
----------------	------------------	---------------	--------

---

## Sales

Date of Sale	Sales Price	Deed Number	Instrument Type
11/06/2020	\$0	20132453	A
11/06/2020	\$0	20132454	A
06/14/2000	\$0	KJ7071	CD
06/14/2000	\$56,000	KH2393	WD
12/17/1999	\$32,000	JX5368	TD
02/22/1985	\$1,000	W56049	QC
08/15/1975	\$26,750	K60190	UN
04/24/1967	\$13,400	6158-455	UN

Sketch

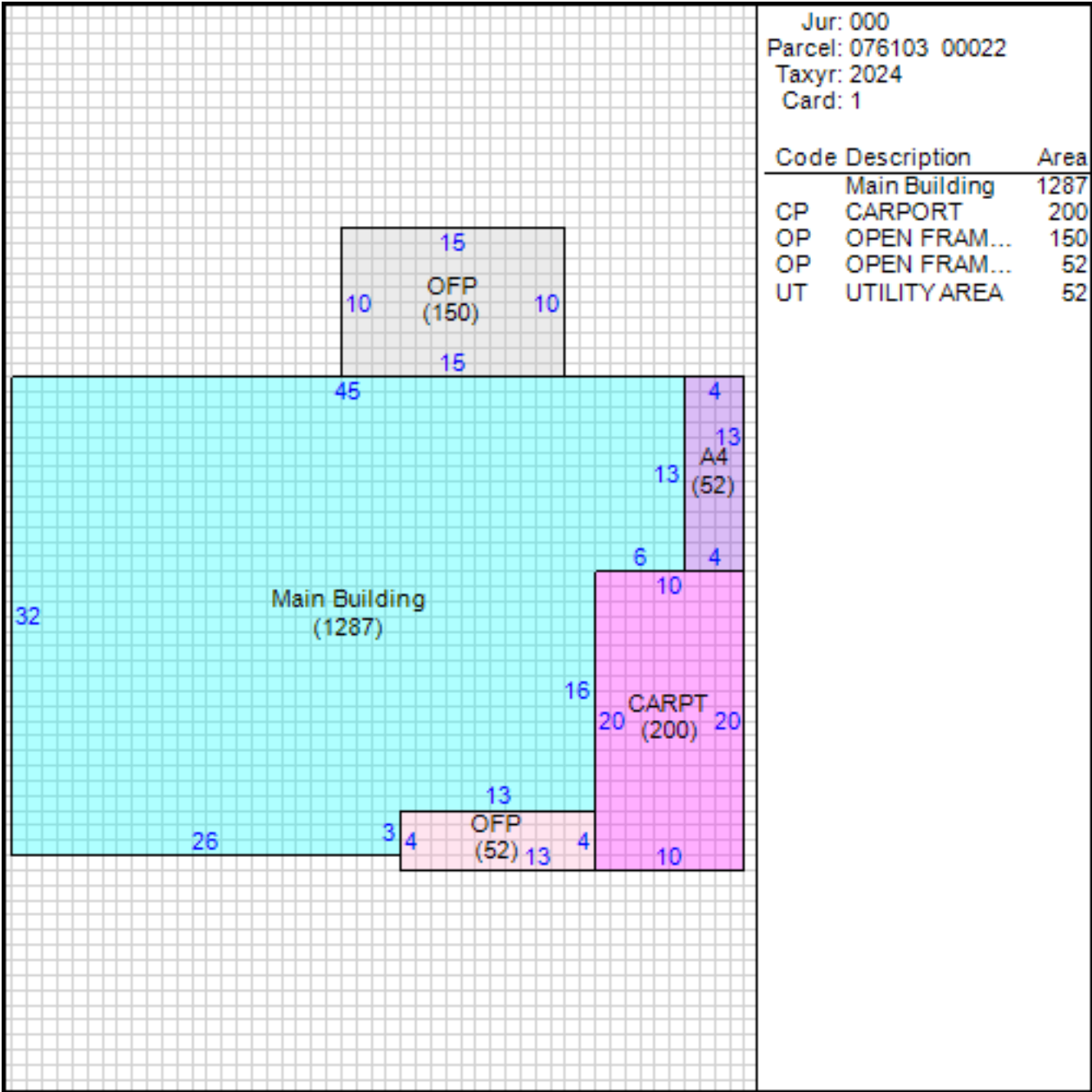

Jur: 000  
Parcel: 076103 00022  
Taxyr: 2024  
Card: 1

Code	Description	Area
	Main Building	1287
CP	CARPORT	200
OP	OPEN FRAM...	150
OP	OPEN FRAM...	52
UT	UTILITY AREA	52